



3/21-23 Keats Avenue Rockdale NSW

2 1 1

Nestled in the heart of Rockdale, just moments from Rockdale Plaza, the railway station, bus exchange, and reputable schools, is this well-presented and tranquil first-floor, north-east facing 2-bedroom unit.

- Two generously-sized bedrooms.
- Spacious living room with high ceilings.
- Wrap-around balcony off the living area, offering a sunny outlook.
- Tiled interior throughout.
- Modernised kitchen with updated appliances.
- Updated bathroom with a large window.
- Internal laundry for added convenience.
- This property comes with a substantial 19 sqm Lock Up Garage, ensuring secure parking with easy street access and extra room for storage.
- Brand new built-in wardrobes are soon to be installed in both bedrooms, providing ample storage space.
- Long term tenants welcome

Don't miss out on this fantastic opportunity! Schedule a viewing today.

View : <https://www.rwproperty.com.au/lease/nsw/st-george/rockdale/residential/apartment/7949062>



Victoria Paneras
02 9599 9985



Ricky May
02 9599 9985

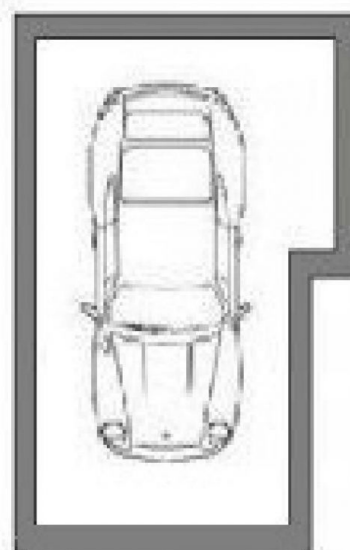

FLOOR PLAN



3/21-23 Keats Avenue Rockdale

WARNING: DISCLAIMER This information is not to be relied upon. It is strictly used for marketing and illustration purposes only. All measurements are approximate. Not to scale. No liability accepted. You must rely on your own inquiries and seek advice from your solicitor.